

Directions to Canvas Workshops and Faculty Support Services

1. Take the **stairs from the lobby**, veer left, walk through the lounge, and veer left again. Walk past the copy machine and take the first right to arrive at **2 East**.

OR

2. Go down the stairs, walk past **Circulation**, and take the **elevator** or **central stairs** to the second floor. Pass the copy machine and take the first right to arrive at **2 East**.

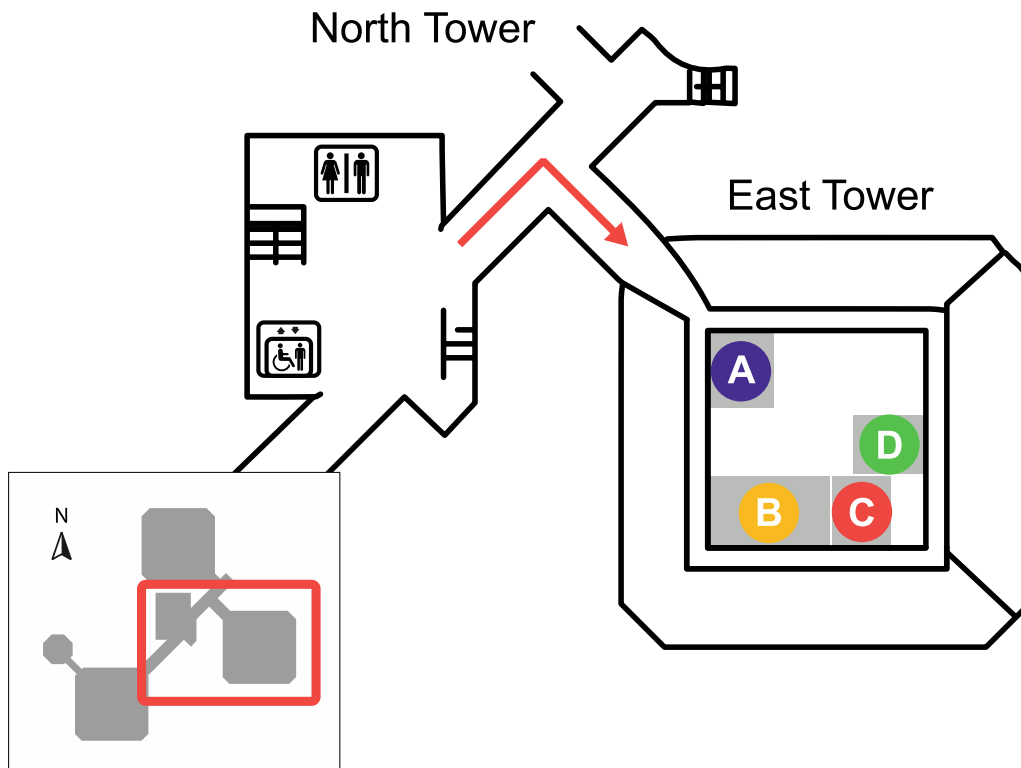

A

2650

Mini-Consultations & Walk-Ins

- Enter the **first** door on the **right**.
- The first door on the **left** is room **2650** for Mini-Consultations and Walk-Ins.

C

2635

Workshops

- Enter the **first** door on the **right**.
- Continue to the end of the hallway and turn **left**.
- Continue down the hall to room **2635** on the **left** for Workshops.

B

2640

One-Hour Consultations

- Enter the **first** door on the **right**.
- Continue to the end of the hallway and turn **left**.
- Arrive at room **2640** immediately on the **left** for One-Hour Consultations.

D

2699C Sony Room

General Meeting Space

- Continue **straight** down the hallway.
- Turn **right** at the end of the hallway.
- Continue down the hall to room **2699C**, the **Sony Room**, on the **right**.